



Marc Page
Sputtermill Ranch



GALA/LAMAS Conference 2005

Charlottesville, Virginia



"Back to School"

Welcome "Back to School"

Welcome to all the GALA and LAMAS members who have taken the time to attend our 2005 "Back To School" conference. Thank you for taking the time from a busy summer schedule to help make this conference a success. We hope you will enjoy your back to school theme by:

- learning new exciting information
- refreshing your existing knowledge
- making some new friends
- catching up with old friends
- and generally having fun and enjoying the atmosphere!

Thank you also to the speakers and volunteers who have given much time and effort to provide us with a broad range of knowledge and skills.



GALA-LAMAS Joint Conference
Aug. 18-21, 2005





Conference Committee

2005 GALA/LAMAS Conference Committee:

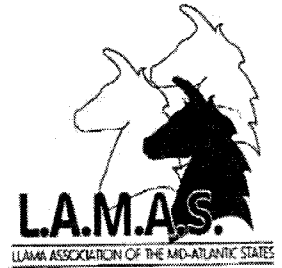

Conference Chairs:

GALA - Paige McGrath, Lower Sherwood Farm

LAMAS - Marian Bruffy, Free State Llamas

Conference Planner - Mark Thaler, Thaler Corporation

Conference Notebook - Linda Brown, Graustark Farm LLC

Photo Contest - Darlene Dorang, Elk Mountain Llamas

Gabrielle Stuart, North Star Llama Ranch

Fiber Program - Shirl Estrada, Lofty Llama Fine Yarns & Crafts

Raffle Coordinator - Joyce Hall, Posey Thisisit Llamas

Youth Program Coordinator - Norma Sides, Cornerstone Farm

Clinic Coordinator - Heidi Swain, Stuart Mill Farms

Icebreaker - Carol Reigh, Buck Hollow Llamas

Thank You!

A GREAT BIG THANK YOU

to all the volunteers that have generously given their time and talents to making the conference a success this year!!! Without **YOU** there would be no conference at all!

A GREAT BIG THANK YOU

to all the people that generously donated items to make the raffle and the auctions a success this year!!! Without **your** support there would be nothing to auction or to raffle and we really appreciate all that you have done in support of LAMAS & GALA.

A GREAT BIG THANK YOU

to all the people that will buy lots of raffle tickets and will bid high and generously at the auctions!!! Without **your** support our auctions and raffle would not provide the needed sums to run GALA & LAMAS and support other lama related organizations and research throughout the year!

Doubletree Room Locations

DOUBLETREE HOTEL CHARLOTTESVILLE - LOBBY LEVEL

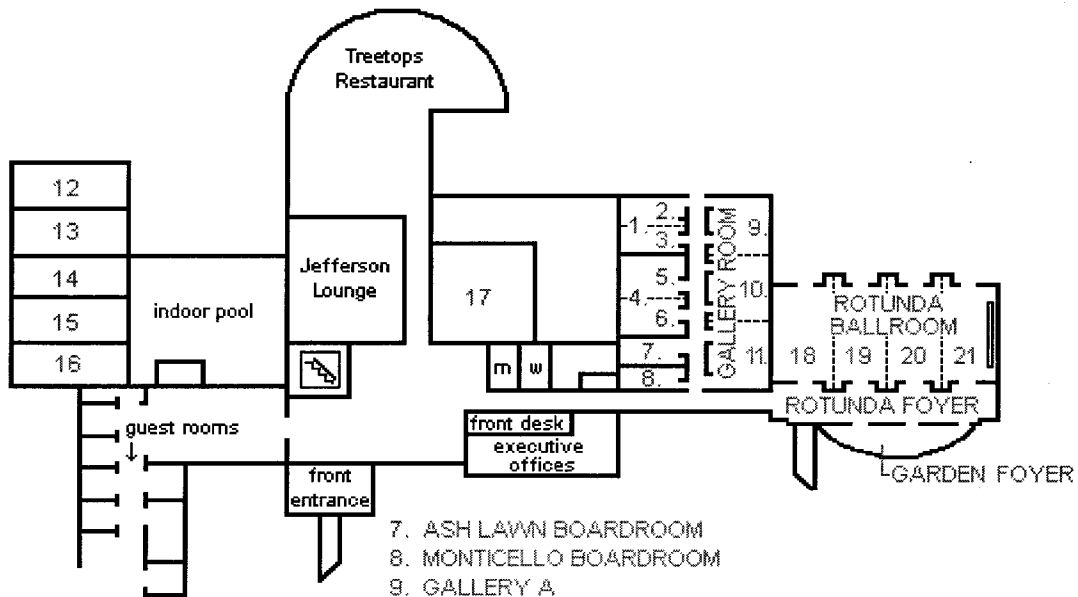

- | | | |
|--------------------|----------------------------|-------------------|
| 1. ALBEMARLE ROOM | 7. ASH LAWN BOARDROOM | 16. JAMES MADISON |
| 2. ALBEMARLE B | 8. MONTICELLO BOARDROOM | 17. GIORGIO'S |
| 3. ALBEMARLE A | 9. GALLERY A | 18. ROTUNDA A |
| 4. MONDOMAINE ROOM | 10. GALLERY B | 19. ROTUNDA B |
| 5. MONDOMAINE B | 11. GALLERY C | 20. ROTUNDA C |
| 6. MONDOMAINE A | 12. PRESIDENTIAL BOARDROOM | 21. ROTUNDA D |
| | 13. GEORGE WASHINGTON | |
| | 14. THOMAS JEFFERSON | |
| | 15. JAMES MONROE | |

DOUBLETREE HOTEL CHARLOTTESVILLE - FIRST FLOOR

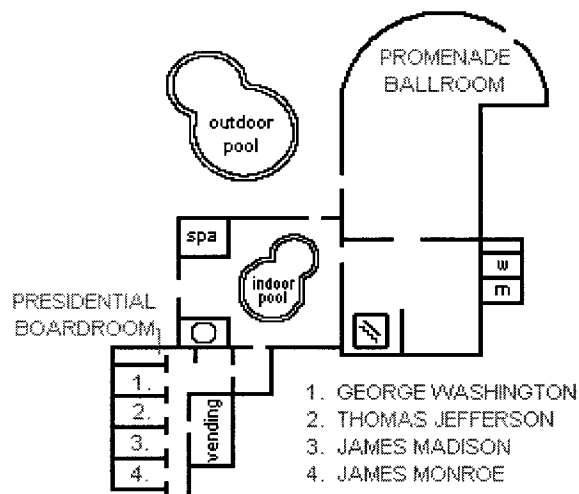

- | |
|----------------------|
| 1. GEORGE WASHINGTON |
| 2. THOMAS JEFFERSON |
| 3. JAMES MADISON |
| 4. JAMES MONROE |

Conference Schedule

This is just a quick "What's Happening When" Table to help you plan the clinics, seminars and events you may want to attend. The full schedule with descriptions are on the following pages. Please watch for changes and/or updates to the schedule.

Friday, August 19						Youth Program
7:00-8:00	Breakfast on your own					
7:30-8:30	Registration in Rotunda			ALSA Wool Divisions 101 (8:00-12:00)	Fiber Antics - Felting Workshop I (8:00-12:30)	Registration
8:45	Orientaton					
9:00-10:00	Keynote Address - Misson Acomplished					Keynote Address
10:00-10:15	Recess					Homeroom Meeting
10:15-11:45	Show and Tell - South American Adventure	Psychology Prey vs Predator				
12:00-1:15	Lunch					
1:15-3:00	"Square Dancing" - Showmanship Workshop		Driver's Ed Trailer Driving	Show Clinic (1:15-5:00) Conformaton & Movement	FiberAntics Felting Workshop II (2:00-6:30)	Field trip
3:00-3:15	Recess					
3:15-4:30	Shop - Farm Machinery	Training - Who's the Boss (3:15-4:45)	Driver's Ed Trailer Maintenance			
5:00 - ?	Assembly - GALA Annual Meeting					
6:30-7:30	Social Hour					
7:30	Dinner					

Saturday August 20						Youth Program
7:00-8:00	Breakfast on your own					
1st period 8:45-10:00	Economics - Tax Strategies	Sex Education - Reproducton & Neonates	Home Ec. - Llama Shearing	Llamas & Alpacas 101 - Basic Care & Maintenance	Algebra - Carding	Youth Judging
10:00-10:15	Recess					
2nd Period 10:15-12:00	Science - Adv, Repro Tech.	Shop - Fencing Options	Health - Herd Management	P.E. - Obstacle Training	History Spinning	Youth Judging Lab
12:00-1:15	Lunch					
3rd Period 1:15-3:00	Teacher's Lounge Sally Taylor	Health - Homeopathy & Western Medicine	Social Studies - CWG & Gov't relations	P.E. - Jackpot Obstacle basics	Trigonometry Triangle Loom	Training Lab
3:00-3:15	Recess					
4th period 3:15-?	LAMAS Annual Meeting					
3:15-4:45	Teacher's Lounge Ron Pollard DVM	Intramurals - Establishing a 4H group			Natural Science Bodacious Blooms	Arts & Crafts
5th Period 4:45-6:00	Teacher's Lounge John Mallon	Science - Adv, Repro Tech	Health - Parasites! (Schedule change)		Assembly Fiber Follies	Quiz Bowl Team Competition
6:00-7:00	Social Hour					
7:00	Dinner and Auction					Graduaton Dinner & Dance

Sunday, August 21						Youth Program
9:00-11:00						Youth Jackpot Obstacle Competi- tion
9:00-10:15	TBA/John Mallon	Home Ec. - Alpaca Shearing	Computer Science - Ad layouts, Inter- net & electronic jargon	Health - Parasites! (Schedule change)	Art - Painting with Fiber	
10:15-11:30		Economics - Marketing, Contracts & Guidelines			Sex Education - Lockerhooking	
11:30		Brunch				

Conference Full Schedule

THURSDAY	
1:00pm	Check In for vendors and animals
4:00-7:00	Registration and farm display set-up- Rotunda Ballroom
5:00-9:00	Supper on your own
7:00-10:00	Icebreaker social with cash bar and appetizers- Promenade Ballroom & Poolside

FRIDAY WORKSHOPS & CLINICS				
7:00-8:00	Breakfast on your own			
	Subject	Room Assignment (subject to change)		
7:30-8:30	Registration	Rotunda		
8:00-12:00	ALSA Wool Divisions 101	George Washington & Tent	Terry Duespohl & Toni Mahoney Knie	Understanding the different fiber categories by which ALSA divides show classes. Proper fiber terminology and a hands-on evaluation.
8:00-12:30	FiberAntics Workshop I	Promenade		Pre-registration required
8:45-9:00	Orientation	Rotunda		
9:00-10:00	KeyNote Address	Rotunda	Dan & Dale Goodyear	"Mission Accomplished"
10:00-10:15	Recess - Rotunda Ballroom & Foyer			
10:00-12:00	GALA Board Mtg -	Albemarle		
10:15-11:45	Show and Tell	James Madison	Sally Taylor	The South American Adventure - slides and the history of llama selection in South America
	Psychology	Thomas Jefferson	John Mallon	The differences between prey animals and predators
12:00-1:15	Lunch			
1:15-3:00	Square Dancing	Thomas Jefferson	Tabbethia Haubold	Showmanship Clinic
	Driver's Ed- Trailer Driving	James Madison	Ross Curtis	Learn the how to's and pitfalls of maneuvering with a trailer
	Show Clinic	George Washington & Tent	Terry Duespohl & Toni Mahoney Knie	Conformation and Movement
2:00-6:30	FiberAntics Workshop II	Promenade		Pre-registration required
3:00-3:15	Recess - Rotunda Ballroom & Foyer			
3:15-4:30	Driver's Ed - Trailer Maintenance	James Madison	Kip Hall & Tim Hanger	Basic truck and trailer maintenance
	Shop - Farm Machinery	Thomas Jefferson	John Reed	Maintaining your equipment and what no farm should be without
3:15-4:45	Training	James Monroe & tent	John Mallon	Who's the boss? Working with your llamas & alpacas
5:00- ?	Assembly -GALA	James Madison	Annual membership meeting	
6:30-7:30	Social Hour	Rotunda Foyer		
7:30	Dinner	Rotunda		

SATURDAY WORKSHOPS & CLINICS				
7:00-8:00	Breakfast on your own			
7:30-8:30	Registration - Rotunda			
8:45-10:00	First Period	Room	Speaker	Class Description
	Economics	James Monroe	Charles Sher, CPA	Business, operating and tax strategies for llama and alpaca farms
	Sex education	Geo Washington	Rob Pollard, DVM	Reproduction and neonates
	Home Ec.	James Madison	Tabbethia Haubold	Llama shearing with electric clippers
	Llamas & Alpacas 101	Thomas Jefferson	John Mallon	Basic Care and maintenance. From nose to toes.
10:00-10:15	Recess - Rotunda Ballroom & Foyer			
10:15-12:00	Second Period			
	Science	James Madison	Sally Taylor	ART- Advanced Reproductive Techniques- Embryo transfer in llamas and alpacas
	Shop	James Monroe		Setting up and maintaining electric fences and other fencing options
	Health	Geo Washington	Rob Pollard, DVM	Herd Management
	P.E.	Thomas Jefferson	John Mallon	Obstacle Training - Best methods to work with llamas and alpacas
12:00-1:15	Lunch	Rotunda		
1:15-3:00	Third Period			
	"Teacher's Lounge"	Promenade	Sally Taylor	
	Health	Geo Washington	Rob Pollard, DVM	Homeopathy and western medicine
	Social Studies	James Madison	Marsharee Wilcox	Camelid Working Group and Government relations updates and happenings
	P.E.	James Monroe	Marc & Sandy Page	Judging obstacles competitions - concept, rules and hosting guidelines
3:00-3:15	Recess - Rotunda Ballroom & Foyer			
3:15-4:45	Fourth Period			
	Assembly - LAMAS	Thomas Jefferson	Annual Membership Meeting	
	Teacher's Lounge	Promenade	Rob Pollard, DVM	
	Intramurals	James Monroe	Tabbethia Haubold	Establishing a 4H group. Where to start and what's involved.
4:45-6:00	Fifth Period			
	Teacher's Lounge	Promenade	John Mallon	
	Science	James Madison	Sally Taylor	ART- Advanced Reproductive Techniques- Embryo transfer in llamas and alpacas
	Health (Schedule Change)	Geo Washington	Rob Pollard, DVM	Parasites! Best methods of treatment, prevention & control
6:00-7:00	Social Hour	Rotunda Foyer		
7:00-?	Dinner and Auction		Homecoming festivities follow the auction	

SUNDAY			
9:00-10:15			
TBA	Thomas Jefferson	John Mallon	
Home Ec.	Tent	Teri Phipps	Alpaca shearing
Computer Science	George Washington	Paige McGrath	Making the most of your desktop computer. Ad layouts, internet and electronic jargon.
Health (Schedule Change)	James Madison	Rob Pollard DVM	Parasites! Best methods of treatment, prevention & control
10:15 -11:30			
Economics	James Monroe	Teri Phipps	Marketing contracts and guidelines for successful "small breeder" alpaca or llama farms.
11:30-?	Brunch		Awards, Thank you's, Contest winners and Raffle drawings

SOL's in Fiber Education- The Fiber Room Promenade Ballroom

No need to be intimidated; this is school as it should be - fun with a little education on the side. Classes are hand-on and you are welcome to drop in or spend the day on Saturday. . All are invited to share their creations, ideas and methods during the first annual "Fiber Follies". In appreciation of your efforts, prizes shall be awarded for the most original, the most outrageous, and the most opulent.

FRIDAY		
8:00-12:30	FiberAntics Workshop I	Pre registration required
2:00-6:30	FiberAntics Workshop II	Pre registration required
SATURDAY		
8:45-10:00	First Period	
	Algebra	"P=F+C" (Pizazz=Fiber+Color) Combining camelid fiber and colored bits, you will learn the basics of the hand cards and drum carder.
10:15-12:00	Second Period	
	History	"Spinning a Long Tail" A drop spindle or a spinning wheel, give it a whirl, with camelid fiber of course.
1:15-3:00	Third Period	
	Trigonometry	"Triangle Loom- the loom that dresses itself" You will be amazed at how a wooden triangle, some nails, and yarn can produce such breathtaking results.
3:15-4:45	Fourth Period	
	Natural Science	"Bodacious Blooms" Couldn't let the youth have all the fun! Everyone is invited to needle felt gigantic flowers for auction
4:45-6:00	Fifth Period	
	Assembly	"Fiber Follies" or Show and Tell
SUNDAY		
9:00-10:15	Art	"Painting with Fiber" You'll needle felt a small picture on fabric, no artistic talent required
10:15-11:30	Sex education	The ABC'S of Hooking - Locker Hooking that is! The results look like rug hooking but lockering hooking is easier, faster, and a great end use of your camelid roving or bulky yarn.

YOUTH PROGRAM SCHEDULE

THURSDAY EVENING-	Check in with parents; welcome to attend the evening social or make use of the pool.		
FRIDAY YOUTH PROGRAM			
7:00-8:00	Breakfast with family		
7:30-8:30	Registration		
9:00-10:00	Keynote Address	Rotunda	
10:00	Homeroom Meeting	Gallery A	
12:00	Lunch		
1:30	Field Trip		
7:30	Dinner		

SATURDAY YOUTH PROGRAM				
7:00-8:00	Breakfast with family			
7:30-8:30	Registration			
8:45-10:00	First Period	Room	Speaker	Class Description
	Youth Judging	Gallery A	Duespohl/Knie	Introductinto the youth judging program. Learn to evaluate conformation and movement
10:00-10:15	Recess			
10:15-12:00	Second Period			
	Youth Judging Lab	Tent		Hands on practice judging llamas
12:00-1:15	Lunch			
1:15-3:00	Third Period			
	Training Lab	Thomas Jefferson	John Mallon	
3:00-3:15	Recess			
3:15-4:45	Fourth Period			
	Arts & Crafts	Promenade	Dale Goodyear	"Bodacious Blooms"/"Llama in a Bag"
4:45-6:00	Fifth Period			
	Quiz Bowl Team Competition			
7:00-?	Graduation Dinner		Homecoming dance to follow	
SUNDAY YOUTH PROGRAM				
8:00-11:00	Youth Jackpot			
11:30-?	Brunch			

Conference Support Advertisers

Thank you to all our faithful advertisers!

B and B Appliance & Lawn Equipment
Bahama Llamas
Cornerstone Farm
Dove Oaks Farm Llamas
Graustark Llamas LLC
International Camelid Institute
Lazy S Llama Ranch
Lofty Llama Fine Yarns & Crafts
Minuteman Press
Mountain Pride Farm
Mr. Print
Persimmon Hill Farm
Posey Thisisit Llamas
Rock Bottom Sharpening
Siloview Fram
Sonador Farm LLC
Southern States
Taylor Llamas
The Wren's Nest
Twin Creeks Llamas

Conference Speakers

Terry Duespohl and his wife Audean own and operate Willow Springs Farm in Seneca, PA. They have been breeding and showing llamas since 1995. Their herd now numbers 50. Terry is a founding member of the Pennsylvania Llama and Alpaca Association (PLAA) and has served as Secretary and President of the organization. He has been a member of the Board of Trustees of the Camelid Health Foundation, and of the Board of Directors of the ILA. Active in the Alpaca and Llama Show Association (ALSA), Terry is a member of the Grand National committee and has been the show secretary for the past three years. He also serves as the Chair of the Judge's Committee. Terry is in his sixth year as an ALSA-certified Llama and Alpaca Judge. He has judged shows throughout the United States and in Canada and Europe. Terry is also a Practitioner in Training for TTEAM/Camelid Dynamics Training method for llamas and alpacas. He has studied under Marty McGee-Bennett for approximately six years and has co-taught a number of clinics with her. In his "non-llama" life, Terry is an Economics professor in the College of Business at Clarion University of Pennsylvania.

Toni Mahoney Knie and her husband Richard live in Petersburg, Tennessee, south of Nashville, on a 140 acre farm. They have 20 llamas, 6 burros, and a herd of Angus cattle. Both Toni and Richard show performance and halter llamas. Prior to retiring to the farm in Tennessee, Toni was a school teacher in Alabama. Moving to the farm was a natural choice, as Toni and Richard have had horses for years, even when living in Birmingham, and they both like to trail ride and go to shows. In addition to helping Richard manage their farm and showing llamas, Toni is an ALSA Judge, chairman of the performance committee for ALSA, a former treasurer and board member for the Southern States Llama Association, past co-chairman of their annual convention, past secretary and board member of the Tennessee Llama Community, and past show superintendent of the Middle Tennessee Spring Llama and Alpaca Show held in Murfreesboro, TN. Animals have always been an intergral part of Toni's life, and once she met the quiet and intelligent llama, it was natural that her life would not be complete without making them part of her family also.

Sally Taylor and her husband, Paul, have been leaders in the llama phenomenon since 1975. They played a key role in the creation of the major association of llama breeders (ILA) and created the first real registry for llamas in North America. During the past twenty years they have served as directors of many llama organizations and produced the best-selling video series, All About Llamas. Recently they have spent much of their time in the study of advanced reproduction in camelids, doing research and practical projects at their ranch clinic and also in Chile, Argentina, Peru and the United Arab Emirates. Sally currently serves on the board of the International Llama Registry.

Dan and Dale Goodyear live in Robesonia, Pennsylvania where they have had as many as 250 llamas in their herd at Berry Acres Llamas. Part of their mission is to devote time to educate the public and new owners about llamas. They believe in supporting and participating in organizations devoted to the welfare of llamas.

Dan served on the boards of numerous national organization and committees and is currently serving on the board of directors of the Greater Appalachian Llama and Alpaca Association, and chairs the Government Relations Committee. He has been a member of USAHA for over 14 years and serves on two committees. He is a founding member of the Camelid Alliance. Dan is a graduate of St. Lawrence University. He served as an officer in the United States Marine Corps and spent 34 years in the foundry industry, retiring in 1997. During his business career, Dan served as president of the American Foundry Society, and was recognized by the Reading, Pa. Chamber of Commerce as Businessman of the Year.

Dale received a BA from Skidmore College and an MA from Colgate University. For the past 35 years, she has enjoyed teaching English and has contributed many articles to various llama publications.

In addition to their involvement in the Eastern Llama and Alpaca Festival, Dan and Dale produced Llamalennium and Berry Picking, two production sales held at their farm designed to celebrate the joys of llama ownership and to share the results of their breeding program.

John Mallon: With over 35 years experience in the training of horses, dogs, and birds, John has devoted himself exclusively to all aspects of the llama and alpaca industry since 1981. A popular featured speaker at regional, national, and international venues, and a longtime consultant with an international list of clients, John has averaged 50 to 60 clinics a year since 1994. The enthusiastic response to the Mallon Method has made it hard for him to cut down on "road time" in order to spend more time with his wife, Kathleen McLeod, and his llamas, dogs, cats, and cutting horses on their 28 acre ranch in the beautiful back country of San Diego County, California.

Robert J. Pollard, DVM graduated from UC Davis School of Veterinary Medicine in 1970, after having been one of the first students in Dr. Murray Fowler's zoo and wildlife medicine class. Rob and his wife Suzi moved to Sonora, in the Sierra foothills, and started a small animal practice. As llamas became more popular in the area in 1983, Dr. Pollard used his wildlife medicine experience to work on llamas, and to help the new llama owners. He and his wife own 50 llamas, with almost a dozen other llamas visiting their Valley of the Llama Ranch for breeding, birthing, or medical care. Over the years homeopathy and herbals became a large part of his veterinary practice.

Tabbethia Haubold is the animal science program manager with Cornell Cooperative Extension of Suffolk County, NY and is based at the Suffolk County Farm & Extension Education Center. This farm provides programming for over 50,000 children yearly and is open to the public as well. Tabbethia earned her BS in Animal Sciences from Delaware Valley College in PA and has extensive vet tech experience with all types of livestock. In her current position she is involved in various aspects of administration and education and, of course, leads a 4H llama club. Tabbethia, along with Christopher Magee created the Long Island Livestock Company, llamas and livestock services.

FiberAntics

Nancy was started on her fiber art odyssey five years ago by the purchase of two llamas to protect her dogs from the coyotes that inhabited the mini-farm that she and her husband, John, purchased.

The llama herd quickly grew from two llamas to 20. "What is a person to do with all of the fleece?" Oil Painting had been her art form for over 30 years. Twenty years ago she bought a floor loom for weaving. Pulling from these two interests, fiber art became her new passion, especially wet felting. She also learned to spin and knit. Her first wet felting project was a llama fiber 30 X 50 farm banner to display at the Indiana State Fair. Ever since, Nancy has been hooked on felting. She partnered with Patti to become a cottage business selling their fiber and fiber-art, and teaching. Nancy and Patti named their business FiberAntics... and after being in their classes, you understand the antics part of their name. The love of fiber and the joy of creating beautiful garments, accessories, jewelry, etc., mixed with laughter are things that Nancy wants to share with her students. This enthusiasm for sharing fiber craft and her love of llamas and llama fiber has led Nan to teach felting to both children and adults. In January, they cofounded FiberAntics Fiber Arts Guild and have a large, growing membership.

Marharee Wilcox has been a llama lover since the early 1990's. She and her husband Wellington share life on their Maryland farm with approximately 25 llamas and a variety of other beloved animals. Marharee is past President of LAMAS and has been active for a number of years in government relations for the memberships of GALA and LAMAS as well as working on national and international camelid health and government relations issues through the Camelid Alliance. She is member of USAHA where she serves on several national subcommittees and is also a member of the Camelid Working Group, developing the National Animal Identification plan for all North American camelids.

FiberAntics

Patti lives near Indianapolis, Indiana with her husband. She has three daughters and several grandchildren. She is an RN working in the Neonatal Intensive care unit at a local hospital. They moved to the mini farm 10 years ago and began raising alpacas and llamas. As her herd increased so did her raw materials. A close friend started her spinning and a love of fiber began to blossom. She soon progressed to felting, taking several classes to get the basics down then spending several wonderful days playing, experimenting and perfecting her art. Meeting Nancy at a llama show resulted in a growing friendship and a greater enthusiasm for sharing fiber craft and love of animals. Together they work at least one day a week, pushing the limits, to creating fiber art. They have been teaching classes for three years. She loves sharing her experiences with others in an effort to encourage more people to become involved in this ageold craft.

Shirl Estrada of Lofty Llama Fiber is the coordinator of the Fiber Room. She and partner, Barb Robertson, introduced Lofty Llama Fine Yarns & Crafts late in 1993. Their goal was to explore the multi facets of llama fiber, share their learning experiences, expand the marketability of llama related products and most importantly...have fun!

Fiber Follies

LAMAS/GALA fun-loving volunteers: Mere words cannot do justice to the cast of characters who have graciously offered to share the joys of fiber with you. The versatility of their talents is guaranteed to amaze, educate and entertain.